

# ATV KIT - LinQ 23 US Gal (87 L) Trunk Box - G3

Product: **ATV**  
 Project no: **487804045\_rev2**  
 Instruction Sheet P/N: **487804045**  
 Revision no: **2**  
 Revision date: **March, 2026**  
 Item covered: **LinQ 23 US Gal (87 L) Trunk Box - G3**

The following symbols may be used in this document:

 **WARNING**

Indicates a hazardous situation which, if not avoided, could result in death or serious injury.

 **CAUTION:** Indicates a hazard situation which, if not avoided, could result in minor or moderate injury.

**NOTICE** Indicates an instruction which, if not followed, could severely damage vehicle components or other property.

 **WARNING**

- This kit is designed for specific applicable models only (authorized BRP dealers will confirm model(s)). It is not recommended for units other than the one (those) for which it was sold.
- Should removal of a locking device (e.g. lock tabs, self-locking fasteners, etc.) be required when undergoing disassembly/assembly, always replace with a new one.
- Torque wrench tightening specifications must strictly be adhered to.
- Unless otherwise specified, engine must be OFF when performing any operation on the vehicle.
- Always be aware of parts that can move, such as wheels, transmission components, etc.

 **WARNING**

Some important safety information and/or operating instructions dedicated to the end user might be included in this instruction sheet. Make sure to give the kit part number as well as the instruction sheet included with this kit to the customer. Verify that the customer has access to all the information required for proper use of the accessory.

**NOTE: USE TIGHTENING TORQUES IN THE FOLLOWING TABLE IF NOT OTHERWISE SPECIFIED.**



	GRADE			
	5.8	8.8	10.9	12.9
M4	1.8 ± 0.2 N•m (16 ± 2 lbf•in)	2.8 ± 0.2 N•m (25 ± 2 lbf•in)	3.8 ± 0.2 N•m (34 ± 2 lbf•in)	4.5 ± 0.5 N•m (40 ± 4 lbf•in)
M5	3.3 ± 0.2 N•m (29 ± 2 lbf•in)	5 ± 0.5 N•m (44 ± 4 lbf•in)	7.8 ± 0.7 N•m (69 ± 6 lbf•in)	9 ± 1 N•m (80 ± 9 lbf•in)
M6	7.5 ± 1 N•m (66 ± 9 lbf•in)	10 ± 2 N•m (89 ± 18 lbf•in)	12.8 ± 2.2 N•m (113 ± 19 lbf•in)	16 ± 2 N•m (142 ± 18 lbf•in)
M8	15.3 ± 1.7 N•m (135 ± 15 lbf•in)	24.5 ± 3.5 N•m (18 ± 3 lbf•ft)	31.5 ± 3.5 N•m (23 ± 3 lbf•ft)	40 ± 5 N•m (30 ± 4 lbf•ft)
M10	29 ± 3 N•m (21 ± 2 lbf•ft)	48 ± 6 N•m (35 ± 4 lbf•ft)	61 ± 9 N•m (45 ± 7 lbf•ft)	73 ± 7 N•m (54 ± 5 lbf•ft)
M12	52 ± 6 N•m (38 ± 4 lbf•ft)	85 ± 10 N•m (63 ± 7 lbf•ft)	105 ± 15 N•m (77 ± 11 lbf•ft)	128 ± 17 N•m (94 ± 13 lbf•ft)
M14	85 ± 10 N•m (63 ± 7 lbf•ft)	135 ± 15 N•m (100 ± 11 lbf•ft)	170 ± 20 N•m (125 ± 15 lbf•ft)	200 ± 25 N•m (148 ± 18 lbf•ft)
M16	126 ± 14 N•m (93 ± 10 lbf•ft)	205 ± 25 N•m (151 ± 18 lbf•ft)	255 ± 30 N•m (188 ± 22 lbf•ft)	305 ± 35 N•m (225 ± 26 lbf•ft)

M18     $170 \pm 20 \text{ N}\cdot\text{m}$  (125  $\pm 15 \text{ lbf}\cdot\text{ft}$ )     $273 \pm 32 \text{ N}\cdot\text{m}$  (201  $\pm 24 \text{ lbf}\cdot\text{ft}$ )     $330 \pm 25 \text{ N}\cdot\text{m}$  (243  $\pm 18 \text{ lbf}\cdot\text{ft}$ )     $413 \pm 47 \text{ N}\cdot\text{m}$  (305  $\pm 35 \text{ lbf}\cdot\text{ft}$ )



NOTE: The illustrations in this document show typical construction of the different assemblies and may not reproduce the full detail or exact shape of the parts; however, they represent parts that have the same or similar function.

Installation time is approximately **0.50** hour.

## ICON LEGEND

ICON	INDICATES
	Parts to be discarded
	Parts kept for reinstallation

## REQUIRED TOOLS

REQUIRED TOOL			USE
T1	Drill bit 6.5 mm (17/64 in)		To drill the mounting holes
T2	Drill bit 6 mm (1/4 in)		To drill the storage box base

## PARTS TO BE INSTALLED

ITEM	DESCRIPTION	PART NUMBER	QTY
P1	Storage Box Base	Not available separately	1
P2	Storage Box Cover	Not available separately	1
P3	Cover Gasket (2705,9 mm)	See Service Parts	1
P4	Lid Latch	708201426	2
P5	Retaining Hook	705018888	2
P6	Hinge Pin	Not available separately	2
P7	Lock Assembly with Keys	See Service Parts	1
P8	Lock Backplate	See Service Parts	1
P9	M5 X 16 Torx Screw	250000578	10
P10	M5 Square Nut	232852411	6
P11	M5 Flat Washer	234052670	8
P12	M5 Flanged Elastic Nut	233251494	2
P13	LinQ Fastener	See Service Parts	2
P14	Retaining Ring	See Service Parts	2
P15	M5 X 14 Torx Screw	250000742	8
P16	M5 Specialized Nut	See Service Parts	8
P17	Rubber Stopper Kit (includes P17a to P17d)	715008895	1
P17a	Rubber Stopper	See Service Parts	4
P17b	M5 Flat Washer	See Service Parts	8
P17c	M5 X 25 Torx Screw	See Service Parts	4
P17d	M5 Flanged Elastic Nut	See Service Parts	4
P18	Warning Label (English)	704910065	1

P19

Warning Label (Pictogram)

704910065

1

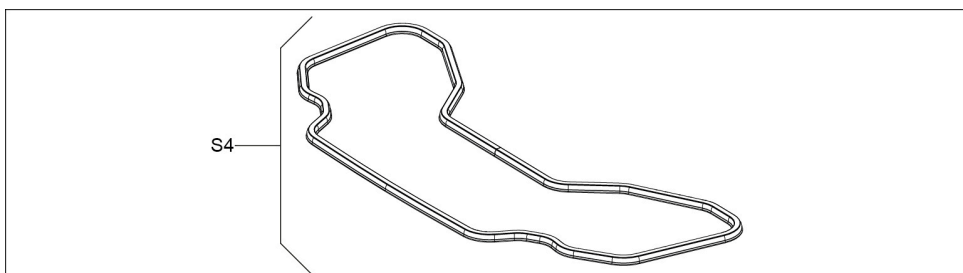
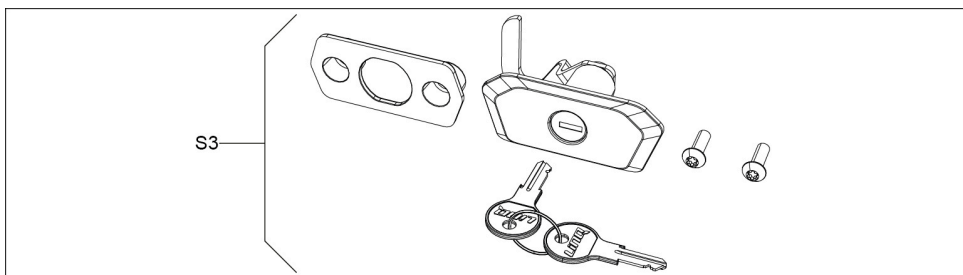
**SERVICE PARTS**

ITEM	DESCRIPTION	PART NUMBER	QTY
S1	LinQ Fastener Kit	715009758	1
S2	LinQ Retaining Hook Kit (Includes S2a to S2d)	715011062	1

S2a	Retaining Hook	705018888	2
S2b	M5 X 16 Self-Locking Torx Screw	250000578	6
S2c	M5 Stainless Flat Washer	234052670	6
S2d	M5 Square Nut	232852411	6
S3	Lock Assembly Kit	715009320	1
S4	Cover Gasket (3000 mm) (To be cut to desired length)	520003132	1
S5	Rubber Stopper Kit	715008895	1

## INSTALLATION INSTRUCTIONS

**NOTE:** This kit is ready to be installed only on the rear luggage rack of the G3L models.

*A = INSTALLATION ON REAR RACK IS GOOD  
B = INSTALLATION ON FRONT RACK IS WRONG*

### Installation On Rear Luggage Rack (with 4 Anchor Points)

1. Insert the retaining hooks [P5] under the outer end of the luggage rack.

2. Pivot and place the rear of the storage box assembly on the vehicle's luggage rack. Check if the retaining hooks [P5] are still in position under the luggage rack.

3. Turn the two (2) LinQ latches [P13] 90 degrees clockwise to secure the trunk to the luggage rack.

## **Installation On Elevated LinQ Anchors (with 3 Anchor Points)**

*A = FRONT OF VEHICLE*

*B = REAR OF VEHICLE*

**1. Lateral LinQ Anchor**

**2. Central LinQ Anchor**

1. Remove and keep the six (6) M5 screws and the six (6) M6 flat washers along with the two (2) retaining hooks and its six (6) M5 square nuts.

2. Locate the seven (7) indents marks and using the 6 mm (1/4 in) drill bit [T2] drill seven (7) holes in the bottom of the cargo box.

1. *Drilling location for rubber stoppers installation*
2. *Drilling location for retaining hook installation*

3. Insert four (4) M5 X 25 self-locking Torx screws [P17c] and the four (4) M5 flat washers [P17b] from the inside out of the cargo box into the rubber stoppers installation holes.

*PARTS REMOVED FOR CLARITY AND SOME TRANSLUCID FOR COMPREHENSION*

1. *M5 X 25 Self-Locking Torx Screw [P17c]*
2. *M5 Flat Washer [P17b]*

4. Insert one (1) rubber stopper [P2a], one (1) M5 washer [P2d] and one (1) M5 hex. flanged elastic nut [P2c] on each screw. Tighten to specification.

1. *Rubber Stopper [P2a]*
2. *M5 Flat Washer [P2c]*
3. *M5 Hex. Flanged Elastic Nut [P2d]*
4. *M5 X 25 Self-Locking Torx Screw [P2b]*

<b>TIGHTENING TORQUE</b>	
M5 Hex. Flanged Elastic Nut [P2d]	3,3 ± 0,2 N•m (29 ± 2 lbf•in)

5. Insert the three (3) previously removed M5 X 16 self-locking Torx screws and three (3) M5 flat washers in the central retaining hook holes.

- Without turning the trunk box over, place one of the previously removed retaining hooks on the three (3) M5 X 16 self-locking Torx screws then insert three (3) M5 square nuts in their dedicated locations. Tighten to specifications.

TIGHTENING TORQUE	
M5 X 16 Self-Locking Torx Screw	3,3 ± 0,5 N•m (29 ± 4 lbf•in)

- Install the trunk box on the rear rack as described at the beginning of this document.

### ***Adjusting LinQ Fasteners***

- If necessary, slightly loosen the eight (8) M5 X 14 Torx screws [P15].

2. Repeat the storage box installation steps.
3. Tighten the eight (8) M5 X 14 Torx screws [P15].

<b>TIGHTENING TORQUE</b>	
M5 X 14 Torx Screw [P15]	3.3 ± 0.2 N•m (29 ± 2 lbf•in)

## HOW TO USE

1. To open the trunk box, release the lid latches by tilting the top of the lever downwards.

2. Make sure the lock [P7] is unlocked.

3. Open the trunk box cover.

## OPTIONAL PARTS INSTALLATION

### LINQ LITE MULTI HOLDER (P/N 715008087)

**NOTE:** Up to three (3) LinQ Lite Multi Holder (P/N 715008087) can be installed to add LinQ Lite accessories to your rear trunk box. For additional information, refer to the [INSTRUCTION SHEET](#) 487804174.

### LINQ TOOL HOLDER (P/N 715008896)

**NOTE:** LinQ Tool Holder Kit (P/N 715008896) sold separately.

For additional information, refer to the [INSTRUCTION SHEET](#) 487803353.

## **PARTS PREPARATION**

1. Drill the 6.5 mm (17/64 in) [T1] holes in the drilling spots as shown.

*TYPICAL*

## **INSTALLATION INSTRUCTIONS**

1. Insert the two (2) M6 X 25 Torx screws in the Tool holder straps as shown.

2. Install the two (2) straps assembly on the trunk box. Ensure to install the straps with opening facing upward.

*LH SIDE*

3. Install the M6 flat washers and the M6 hex. elastic nuts on the M6 X 25 Torx screws. Tighten to specification.

1. M6 X 25 Torx Screw
2. M6 Flat Washer
3. M6 Hex. Elastic Nut

<b>TIGHTENING TORQUE</b>	
M6 Hex. Elastic Nut	7.5 ± 1 N•m (66 ± 18 lbf•in)

## SAFETY LABEL

This product comes with the following label containing important safety information. The label should be considered a permanent part of this product. If the label comes off or becomes hard to read, please contact an authorized dealer for FREE OF CHARGE replacement. Any person who intends to use this product should read and understand the information contained on the label before doing so.

 <b>WARNING</b>
<ul style="list-style-type: none"> <li>• NEVER carry flammables or dangerous liquids inside the cargo box. If ignited, this can lead to an explosion and cause severe injury or death.</li> <li>• No cargo is allowed on the lid.</li> <li>• Maximum load capacity: 35 kg (77 lb), evenly distributed and secured.</li> <li>• NEVER exceed the cargo and vehicle's load capacities.</li> <li>• For maximum load specifications, refer to labels on the vehicle or to the operator's guide.</li> </ul>

A Pictogram warning label is available in the kit and must be installed in accordance with Market Regulation. To install the Pictogram safety label, do the following:

- Clean the entire original label surface using isopropyl alcohol and dry thoroughly.
- Carefully install the Pictogram safety label OVER the original label.

•	 <b>WARNING</b>
<ul style="list-style-type: none"><li>• NEVER carry flammables or dangerous liquids inside the cargo box. If ignited, this can lead to an explosion and cause severe injury or death.</li><li>• No cargo is allowed on the lid.</li><li>• Maximum load capacity: 35 kg (77 lb), evenly distributed and secured.</li><li>• NEVER exceed the cargo and vehicle's load capacities.</li><li>• For maximum load specifications, refer to labels on the vehicle or to the operator's guide.</li></ul>	

*WARNING LABEL POSITION*